

# landscape

architecture **australia**



The Role of Competitions **Canberra Parklands** Hobart Waterfront **Remembering George Seddon**  
Shared Landscapes for Apartments **Creating Communal Spaces** Sustainable Housing Models

# Nova

The use of indigenous plant species and local materials for the courtyards of these apartments in Zetland, Sydney, was inspired by the palette of the Sydney Bush School movement.

## Project Statement:

This project consists of 119 apartments in four separate buildings, arranged around two large common courtyards. The location of Nova between the Central Park and Tote Park ensures that the larger active space requirements of the projects' residents are met. The communal courts have been developed with the aim of satisfying residents' more intimately scaled recreational needs, and are arranged as a graphic sequence of rooms, segmenting the central open space in a linear manner. The two courts are characterized by bold contemporary patterning, which can be read at ground level or from the overlooking balconies.

project  
Nova  
Victoria Park  
Zetland

landscape architect  
McGregor + Partners

project team  
Project director:  
Adrian McGregor  
Project manager:  
Philip Coxall  
Project team:  
Rupert Carmichael

architect  
Turner Associates

developer  
Waltcorp

builder  
Walter Construction Group

photographer  
Brett Boardman

right  
Willow eucalypts on grass mounds amid gravel paths and waves of native grasses characterize the Nova courtyards.





above  
 The designers took inspiration from the traditional palette of the Sydney Bush School to create this modern Australian garden.

opposite page  
 Oval mounds allow maximum soil depth for tree growth. An internal circulation system keeps the gardens and residences separate.

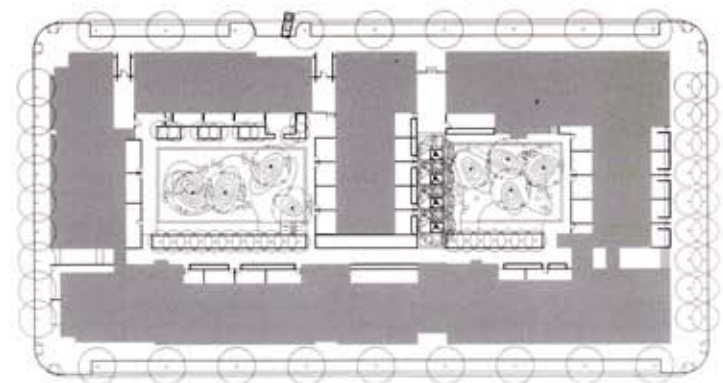

0 5 10 20  
 Site plan 1:1000